

HALEY'S DITCH REMEDICATION AND RESTORATION GRADING AND SWP3

CITY OF AKRON
COUNTY OF SUMMIT
STATE OF OHIO
2009

THE CONTRACTORS/SUBCONTRACTORS MUST FILE A CO-PERMITTEE UNDER THE PERMITTED OSPA CONSTRUCTION STORM WATER PERMIT _____ BY SIGNING BELOW, THE NOI PERMITTEE AND CO-PERMITTEE HAVE ACKNOWLEDGED THAT THEY HAVE FAMILIARIZED THEMSELVES WITH SWP3 DRAWINGS PRIOR TO CONSTRUCTION AND WILL ADHERE TO THE REQUIREMENTS IN THE OSPA PERMIT AND THESE PLANS.

NOI PERMITTEE:

SIGNATURE _____ DATE _____
CONTACT NAME: _____
CONTACT NUMBER: _____
CONTACT ADDRESS: _____

NOI CO-PERMITTEE:

SIGNATURE _____ DATE _____
CONTACT NAME: _____
CONTACT NUMBER: _____
CONTACT ADDRESS: _____

NOI CO-PERMITTEE:

SIGNATURE _____ DATE _____
CONTACT NAME: _____
CONTACT NUMBER: _____
CONTACT ADDRESS: _____

NOI CO-PERMITTEE:

SIGNATURE _____ DATE _____
CONTACT NAME: _____
CONTACT NUMBER: _____
CONTACT ADDRESS: _____



PREPARED FOR: _____

LOCKHEED MARTIN
1210 MASSILLON ROAD
AKRON, OHIO 44315
CONTACT: STEVE VARDAS
PHONE: 330-796-2185

PREPARED BY: _____

GPD GROUP
520 S. MAIN STREET
AKRON, OHIO 44311
CONTACT: MATT LASCOLO
PHONE: 330-527-2100

DRAWING INDEX

- SW-1 TITLE SHEET
- SW-2 PROJECT KEY PLAN
- SW-2A PROJECT NOTES
- SW-3 SOUTH WORK ZONE -- STAGE 1
- SW-4 SOUTH WORK ZONE -- STAGE 2
- SW-5 SOUTH WORK ZONE -- STAGE 3
- SW-6 MIDDLE WORK ZONE -- STAGE 1
- SW-7 MIDDLE WORK ZONE -- STAGE 2
- SW-8 MIDDLE WORK ZONE -- STAGE 3
- SW-9 NORTH WORK ZONE -- STAGE 1
- SW-10 NORTH WORK ZONE -- STAGE 2
- SW-11 NORTH WORK ZONE -- STAGE 3
- SW-12 SITE DETAILS
- SW-13 SITE DETAILS

NOTE: DESIGN/BUILD USE ONLY

UNDERGROUND UTILITIES

2 WORKING DAYS
BEFORE YOU DIG
(TOLL FREE)
CALL 800-362-2764
OHIO UTILITIES PROTECTION SERVICE
NON-MEMBERS
MUST BE CALLED DIRECTLY

REV.	DATE	DESCRIPTION

HALEY'S DITCH
REMEDICATION AND RESTORATION
GRADING & SWP3

TITLE SHEET

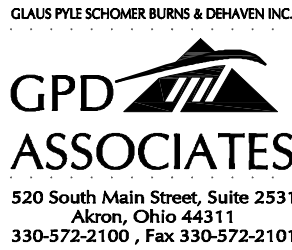

DESIGNED	DATE
JR	4-16-09
DRAWN	DATE
MLH	4-16-09
CHECKED	DATE
MLH	4-17-09

JOB NO.
2009213.00

SW-1

TYPE OF CONSTRUCTION ACTIVITY

1. THE PROPOSED HALEY'S DITCH REMEDIATION AND RESTORATION PROJECT IS PART OF A VOLUNTARY ACTION PLAN INITIATED BY LOCKHEED MARTIN. THE PROJECT INVOLVES VOLUNTARY REMEDIAL EARTHWORK ACTIVITIES TO REMOVE SEDIMENTS AND SOILS ALONG HALEY'S DITCH THAT HAVE BEEN IMPACTED BY POLYCHLORINATED BIPHENYLS (PCBS). ALL REMEDIATION AND RESTORATION ACTIVITY SHALL BE IMPLEMENTED BY THE LOCKHEED MARTIN REMEDIATION PLAN PER APPROVAL BY THE UNITED STATES ENVIRONMENTAL PROTECTION AGENCY (US EPA) FOR RISK-BASED DISPOSAL OF PCB REMEDIATION WASTE AND BY THE UNITED STATES ARMY CORPS OF ENGINEERS IN CONFORMANCE WITH NATIONWIDE PERMIT 38.

REMEDIATION EARTHWORK ACTIVITIES WILL INCLUDE EXCAVATION OF SOIL TO A DEPTH OF 1-FOOT TO 3- FEET. EXCAVATED SOILS CONTAINING PCB'S ABOVE THE REMEDIATION LIMIT SHALL BE ASSIGNED TO THE REMEDIAL PLAN. THE DISTURBED LIMIT OF EARTHWORK IS REPRESENTED ON THE GRADING PLAN. THE LIMIT OF DISTURBANCE IS PLANNED TO REMAIN WITHIN THE 9.13-ACRE PROJECT AREA SHOWN ON THE PLAN. REMEDIAL ACTIVITY MAY CAUSE A MINOR EXPANSION OF THE DISTURBANCE LIMITS TO ALLOW ACCESS AND STAGING OF EQUIPMENT AND MATERIALS. WORK RIGHT AGREEMENTS FOR THE DELINEATED PROJECT AREA AND ANY SUBSEQUENT WORK LIMITS. ALL DISTURBED AREAS WILL BE RESTORED TO NATURAL OR BETTER THAN EXISTING CONDITIONS IN ACCORDANCE WITH THE LOCKHEED MARTIN RESTORATION PLAN.

RESTORATION EARTHWORK ACTIVITIES WILL INCLUDE CHANNEL, FLOODPLAIN, AND WETLAND ENHANCEMENTS WITHIN THE LIMITS IMPACTED BY REMEDIAL ACTION.

EARTHWORK ACTIVITIES SHALL BE CONDUCTED IN ACCORDANCE WITH THE CITY OF AKRON GRADING PERMIT. EROSION AND SEDIMENT CONTROL BEST MANAGEMENT PRACTICES (BMP'S) SHALL BE CONDUCTED PER THE PROJECT STORMWATER POLLUTION PREVENTION PLAN (SWP3) IN ACCORDANCE WITH OHIO EPA REQUIREMENTS, SUMMIT COUNTY SOIL AND WATER CONSERVATION DISTRICT, AND CITY OF AKRON. THE SWP3 SHALL BE AVAILABLE AT THE PROJECT SITE FOR A REFERENCE TO BMP ACTIVITY. HOWEVER, THE VARIABILITY OF EROSION AND SEDIMENT CONTROL BMP'S WILL BE MODIFIED AS APPROPRIATE TO COMPLETE THE NECESSARY REMEDIAL ACTIVITIES IN ACCORDANCE WITH THE LOCKHEED MARTIN RESTORATION PLAN. THE SWP3 SHALL BE MODIFIED TO INCLUDE THE NECESSARY REMEDIAL ACTIVITY WILL DEPEND ON A NUMBER OF CONSIDERATIONS THAT INCLUDE THE SCOPE OF ACTIVITIES, SITE TOPOGRAPHY, TYPE OF GROUND COVER, WHETHER CONTROLS ARE LAND-BASED OR WATER-BASED, AND OPERATIONAL/MAINTENANCE CONDITIONS. SOILS TARGETED FOR REMEDIATION WILL BE MANAGED TO CONTROL RUNOFF FROM THE REMEDIATION AREA. SOILS TARGETED FOR REMEDIATION WILL NOT BE REUSED ON THE PROJECT SITE.

TREE LOGS AND WOOD MULCH CHIPS SHALL BE HARVESTED AND STOCKPILED ON SITE FROM TREE CLEARING ACTIVITIES. THE STOCKPILED MATERIALS SHALL BE MANAGED AS PART OF THE PROJECT STORMWATER POLLUTION PREVENTION PLAN. THE STOCKPILED MATERIALS WITHIN THE PROPOSED EXCAVATION AREA SHALL BE REMOVED FROM THE SITE FOR DISPOSAL AS A PART OF THE REMEDIAL WORK PLAN.

ALL IMPORT OF SOIL, SAND, GRAVEL AND COBBLE MATERIALS FOR RESTORATION ACTIVITIES WILL BE OBTAINED VIA LOCAL SUPPLIERS FROM A SOURCE THAT DOES NOT CONTAIN PCB'S AT CONCENTRATIONS ABOVE ESTABLISHED CRITERIA.

ALL DISTURBED REMEDIATION SOIL AREAS WILL BE RESTORED WITH CLEAN TOPSOIL, SEEDING, AND PLANTINGS TO INITIATE REFORESTATION OF THE RIPARIAN CORRIDOR.

2. TOTAL AREA OF DISTURBANCE: 9.13 ACRES

3. RUNOFF COEFFICIENTS/IMPERVIOUS AREA: THERE WILL BE NO INCREASE IN IMPERVIOUS AREA UPON COMPLETION OF PROJECT. THEREFORE, THERE IS NO CHANGE IN RUNOFF COEFFICIENTS, AND NO POST CONSTRUCTION WATER QUALITY BMP'S REQUIRED. THE INTENTION OF THE PROJECT IS TO BETTER ENHANCE THE EXISTING CONDITIONS TO A RESTORED RIPARIAN CORRIDOR.

4. DESCRIPTION OF HSG SOILS:
C0-CARBONATE ROCK
C1-C1-CHILLY-URBAN LAND COMPLEX, UNDULATING
C2-C2-CHILLY-URBAN LAND COMPLEX, ROLLING
U1-UDORTHERENTS, SANITARY LANDFILL
U2-URBAN LAND

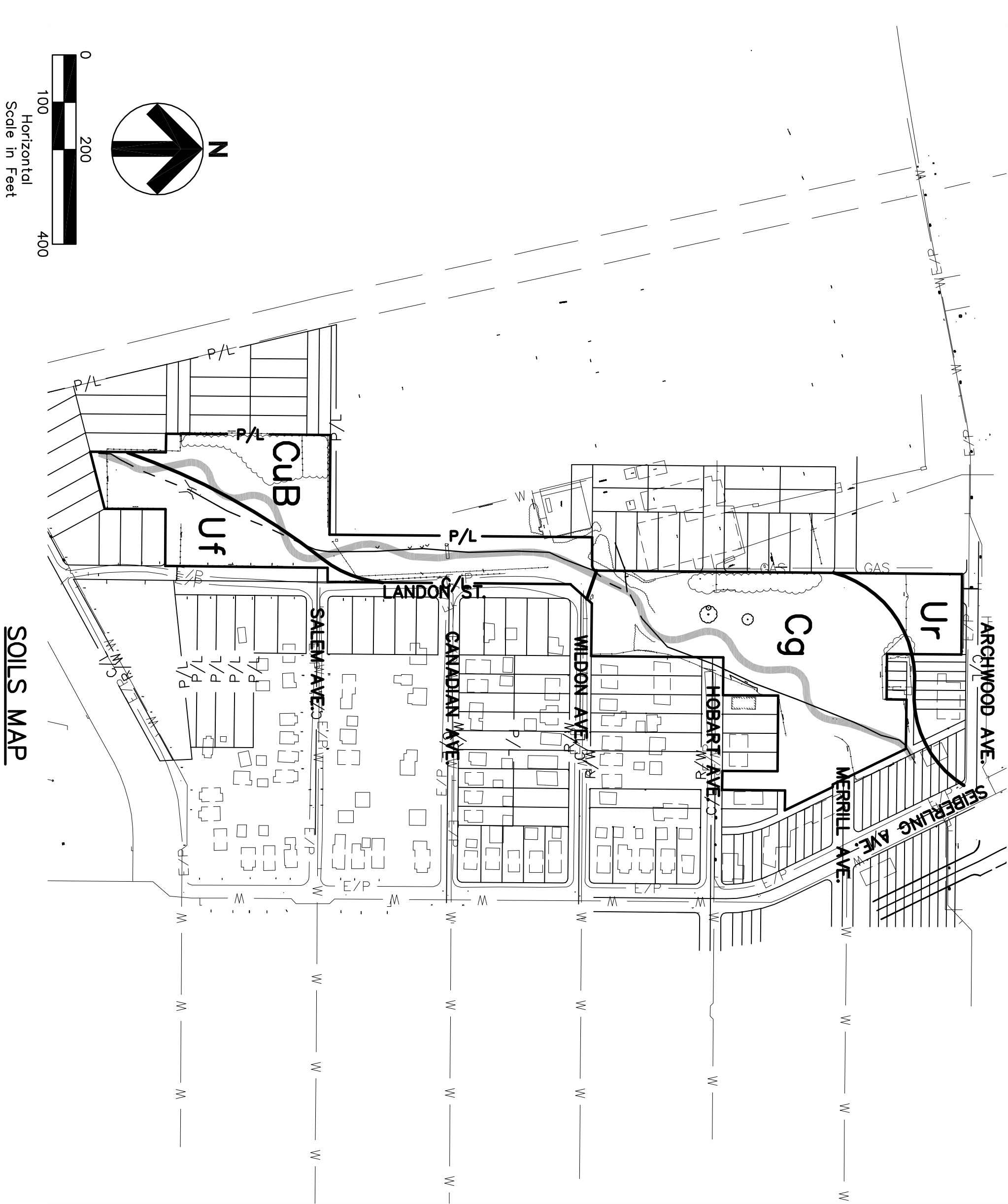

5. THIS CONTRACT DRAWING SHALL BE MADE AVAILABLE ON SITE AT ALL TIMES AND PRESENTED UPON REQUEST. IF UNFORESEEN STORM WATER POLLUTION PREVENTION IS ENCOUNTERED, ADDITIONAL STORM WATER POLLUTION PREVENTION (SWPP) MEASURES MAY BE REQUESTED BY THE OWNER, CITY, PROJECT ENGINEER OR SOIL CONSERVATION SERVICE REPRESENTATIVE AT ANYTIME. SUCH REQUESTS SHALL BE IMPLEMENTED IMMEDIATELY AT CONTRACTOR'S EXPENSE.

6. ALL STORM WATER POLLUTION PREVENTION ITEMS SHALL BE INSTALLED AS SHOWN OR NOTED ON ALL SWP3 PLAN SHEETS.

7. FOR DISTURBED AREAS WITH-IN 50 FEET OF A STREAM REMAINING DORMANT FOR OVER 21 DAYS, TEMPORARY EROSION CONTROLS SHALL BE APPLIED WITH-IN 2 DAYS. FOR DISTURBED AREAS OVER REMAINING DORMANT FOR OVER 21 DAYS, TEMPORARY EROSION CONTROLS SHALL BE APPLIED WITH-IN 7 DAYS. ALL DISTURBED AND ERODED EARTH SHALL BE REGRDED AND SEEDS AS DEFINED ABOVE AND AS SHOWN ON THE TABLE BELOW, TO ESTABLISH STABILITY AND PROVIDE SEDIMENT CONTROL, WHERE POSSIBLE, TEMPORARY SEEDING GROWTH SHALL NOT BE MOWED UNTIL IT HAS GONE TO SEED FOR 1 YEAR.

TEMPORARY SEEDING SPECIFICATIONS:

SEEDING DATES	SEED TYPE	APPLICATION RATE PER 1,000 S.F.
MARCH 1 – AUGUST 15	OATS OR PERENNIAL RYE GRASS OR TALL FESCUE	3#
AUGUST 16 – NOVEMBER 1	RYE, WHEAT OR PERENNIAL RYE GRASS TALL FESCUE	3# 1#
AFTER NOVEMBER 1	STRAW OR HAY MULCH	2-3 BALES 100#
SEED BED PREPARATION	LIME 10-10-10 OR 12-12-12 FERTILIZER	12-15#

8. FOR DISTURBED AREAS WHICH HAVE REACHED FINAL GRADE WITH-IN 50 FEET OF A STREAM, PERMANENT VEGETATION SHALL BE INSTALLED WITHIN 2 DAYS OF FINAL GRADE WORK, WEATHER PERMITTING.

9. CONTRACTOR SHALL INSPECT ALL SWPP MEASURES DAILY AND REPAIR AS NECESSARY TO PREVENT EROSION. SILTATION SHALL BE REMOVED FROM AREAS WHERE FAILURES HAVE OCCURRED AND CORRECTIVE ACTION TAKEN WITHIN 24 HOURS TO MAINTAIN ALL SWPP.

10. CONSTRUCTION ENTRANCES, AND SILT FENCES SHALL REMAIN IN PLACE UNTIL A GOOD STAND OF GRASS HAS BEEN OBTAINED AND OPERATIONS ARE COMPLETE. CONTRACTOR SHALL KEEP SILT FROM ENTERING ANY ADJACENT WATER BODY. IF THE SITE HAS BEEN COMPLETELY STABILIZED, ANY SILT IN PIPES AND DRAINAGE SHALES SHALL BE REMOVED WITHIN 10 DAYS.

11. TEMPORARY SEDIMENTATION AND STORM WATER POLLUTION PREVENTION MEASURES MUST BE INSPECTED AND LOGGED BY THE NOI PERMITTEE, AND NOI CO-PERMITTEES FOR INSPECTION, LOGGING SHALL BE WEEKLY AND AFTER RAIN STORMS. THE LOG FORMS CAN BE OBTAINED AT THE SUMMIT COUNTY SOIL AND WATER CONSERVATION DISTRICT OFFICE. LOG FORMS SHALL BE PLACED IN ONE COMMON AREA AND SHALL BE MAINTAINED IN ASCENDING ORDER OF DATE COMPLETED.

12. IF AT ANY TIME UTILITY COMPANIES ARE REQUIRED TO PARTICIPATE IN CONSTRUCTION, UTILITY COMPANIES MUST COMPLY WITH ALL STORM WATER POLLUTION PREVENTION MEASURES AS DEFINED ON THE STORM WATER POLLUTION PREVENTION PLANS, DETAILS AND NOTES.

13. ALL EXISTING WATER COURSES WITHIN THE PROJECT LIMITS SHALL BE TEMPORARILY PROTECTED DURING LAND CLEARING AND GRADING OPERATIONS. SOILS WITHIN 50 FEET OF SAID WATER COURSES SHALL BE STABILIZED WITHIN 2 DAYS OF THE INITIAL CLEARING / GRADING OPERATION AS SHOWN ON PLANS.

14. IT IS THE NOI PERMITTEES AND NOI CO-PERMITTEES RESPONSIBILITY TO MAINTAIN ALL SEDIMENTATION AND STORM WATER POLLUTION PREVENTION ITEMS AT ALL TIMES.

15. THE FOLLOWING STORM WATER POLLUTION PREVENTION AND SEDIMENT CONTROL MEASURES WILL BE USED ON THIS SITE:

- 1.A. SILT FENCE
- 1.B. CONSTRUCTION ENTRANCE
- 1.C. CONTROL MATTING
- 1.D. ROCK CHANNEL PROTECTION
- 1.E. ROCK CHECK DAMS
- 1.F. TREE PROTECTION FENCING
- 1.G. TYPHOON STRAW CROSSING
- 1.H. BY-PASS PUMPING
- 1.I. TEMPORARY AND PERMANENT SEEDING/LANDSCAPING

16. PERMANENT VEGETATION SHALL NOT BE CONSIDERED ESTABLISHED UNTIL A GROUND COVER IS ACHIEVED WHICH IS MATURE ENOUGH TO CONTROL SOIL EROSION AND WILL SURVIVE SEVERE WEATHER CONDITIONS.

17. ANY PONDED OR ACCUMULATED WATER ENCOUNTERED IN ACTIVE EXCAVATIONS DURING CONSTRUCTION SHALL BE TREATED PRIOR TO DISCHARGE.

18. PERMETER CONTROLS SHALL BE INSTALLED/IMPLEMENTED PER THE CONSTRUCTION SEQUENCE IN THIS PLAN SET (AS REQUIRED). IN AREAS WHERE THE PLANS DO NOT SPECIFY, OR AREAS WHICH ARE IN ADDITION TO PLAN SPECIFICATIONS, PERMETER CONTROLS SHALL BE INSTALLED/IMPLEMENTED WITH-IN 7 DAYS OF GROUNDING ACTIVITIES AND PRIOR TO GRADING OF THE AREA THEY WILL CONTROL.

19. THE SWP3 PLANS SHALL BE KEPT ON SITE AT ALL TIMES DURING CONSTRUCTION (INCLUDING A COPY OF THE NOTICE OF INTENT, AND APPROVED EPA NPDES PERMIT). IT IS THE NOI PERMITTEES AND NOI CO-PERMITTEES RESPONSIBILITY TO MARK (IN A DOMINANT COLOR ON THE SWP3 PLANS) DAILY ANY MINOR MODIFICATIONS MADE TO THE APPROVED SWP3 PLAN SO AS TO KEEP A RECORD OF THE MODIFICATIONS MADE IN THE FIELD. ANY MAJOR FIELD CHANGES TO THE SWP3 PLANS WOULD REQUIRE THE PROJECT ENGINEER TO RE-EVALUATE THE SWP3 PLANS.

REV.	DATE	DESCRIPTION

DESIGNED	DATE
JR	4-16-09
DRAWN	DATE
MLH	4-16-09
CHECKED	DATE
MLL	4-17-09

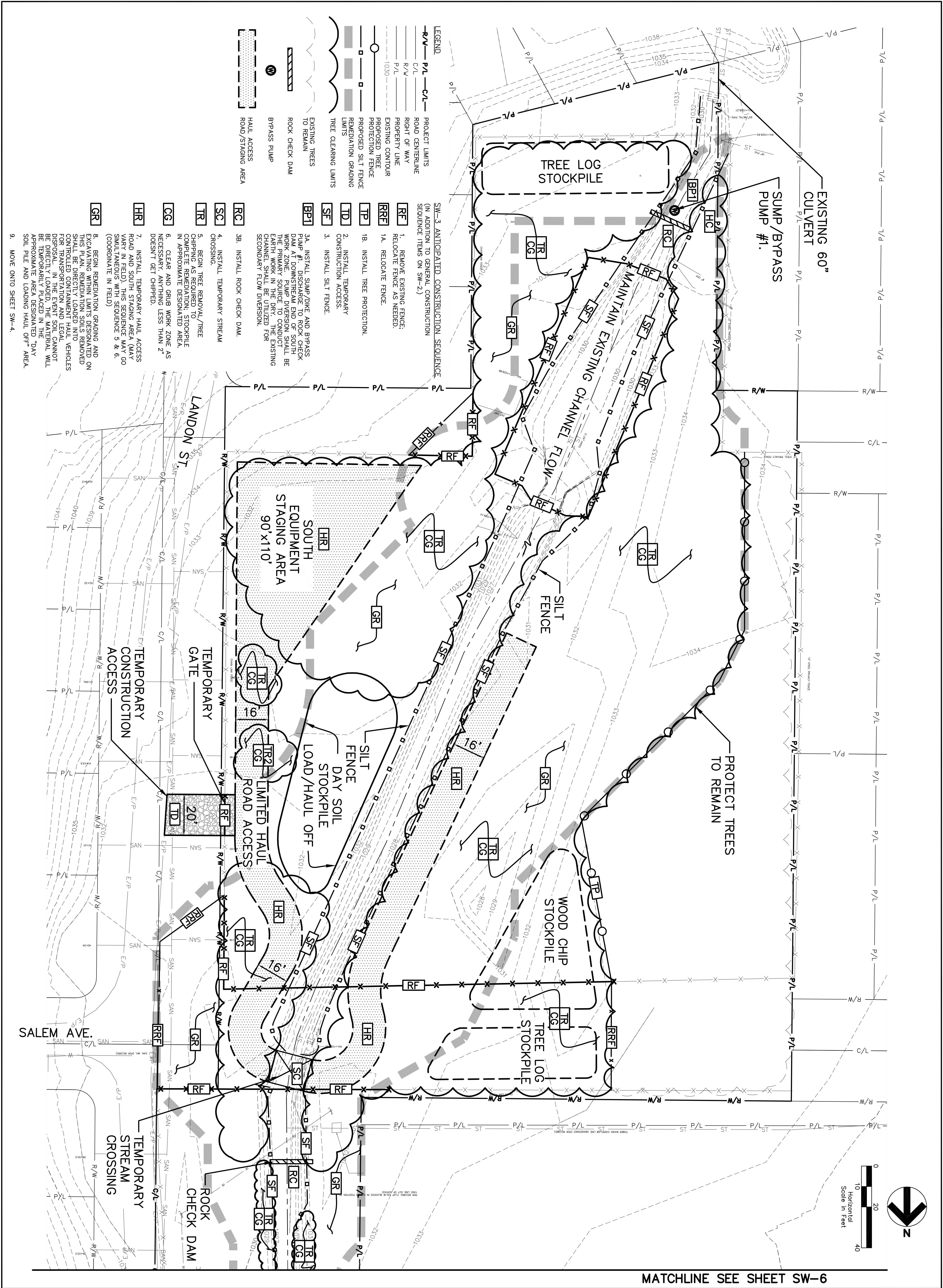

DESIGNED		DATE
JR	4-16-09	
DRAWN		
MLH	4-16-09	
CHECKED		
ML	4-17-09	

JOB NO.
2009213.00

SW-3

HALEY'S DITCH
REMEDATION AND RESTORATION
GRADING & SWP3

SOUTH WORK ZONE - STAGE 1

REV.	DATE	DESCRIPTION

CLAUS PYLE SCHWENBURG & ORSHWEN INC.

GPD ASSOCIATES

520 South Main Street, Suite 2531
Akron, Ohio 44311
330-572-2100 • Fax 330-572-2101

RiverWorks

A Partnership for Stream & Wetland Restoration

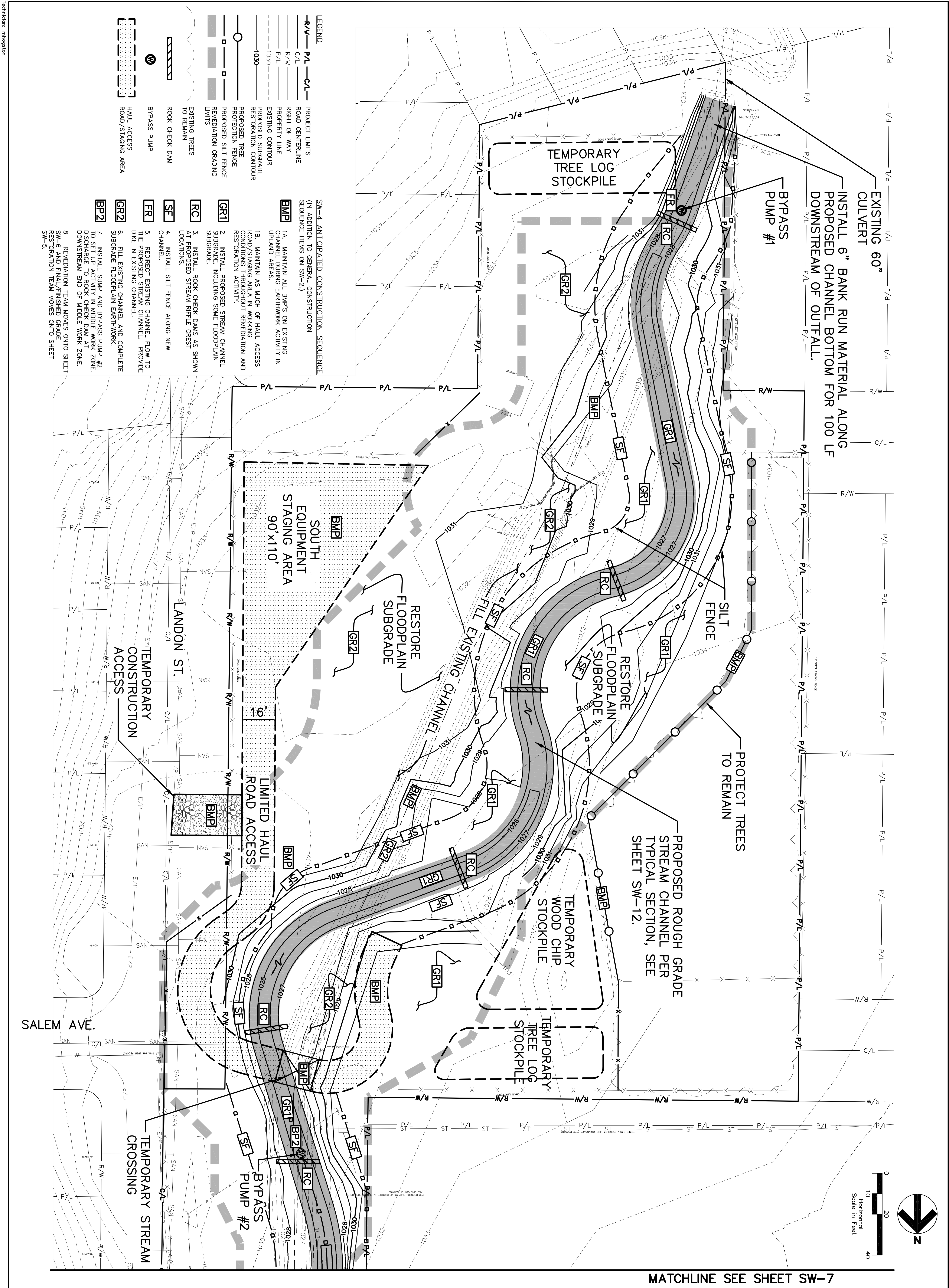

MATCHLINE SEE SHEET SW-7

DESIGNED		DATE
JR	4-16-09	
DRAWN		
MLH	4-16-09	
CHECKED		
MLL	4-17-09	

JOB NO.
2009213.00

SW-4

HALEY'S DITCH
REMEDIATION AND RESTORATION
GRADING & SWP3

SOUTH WORK ZONE - STAGE 2

REV.	DATE	DESCRIPTION

GPD ASSOCIATES
520 South Main Street, Suite 2531
Akron, Ohio 44311
330-572-2100 • Fax 330-572-2101



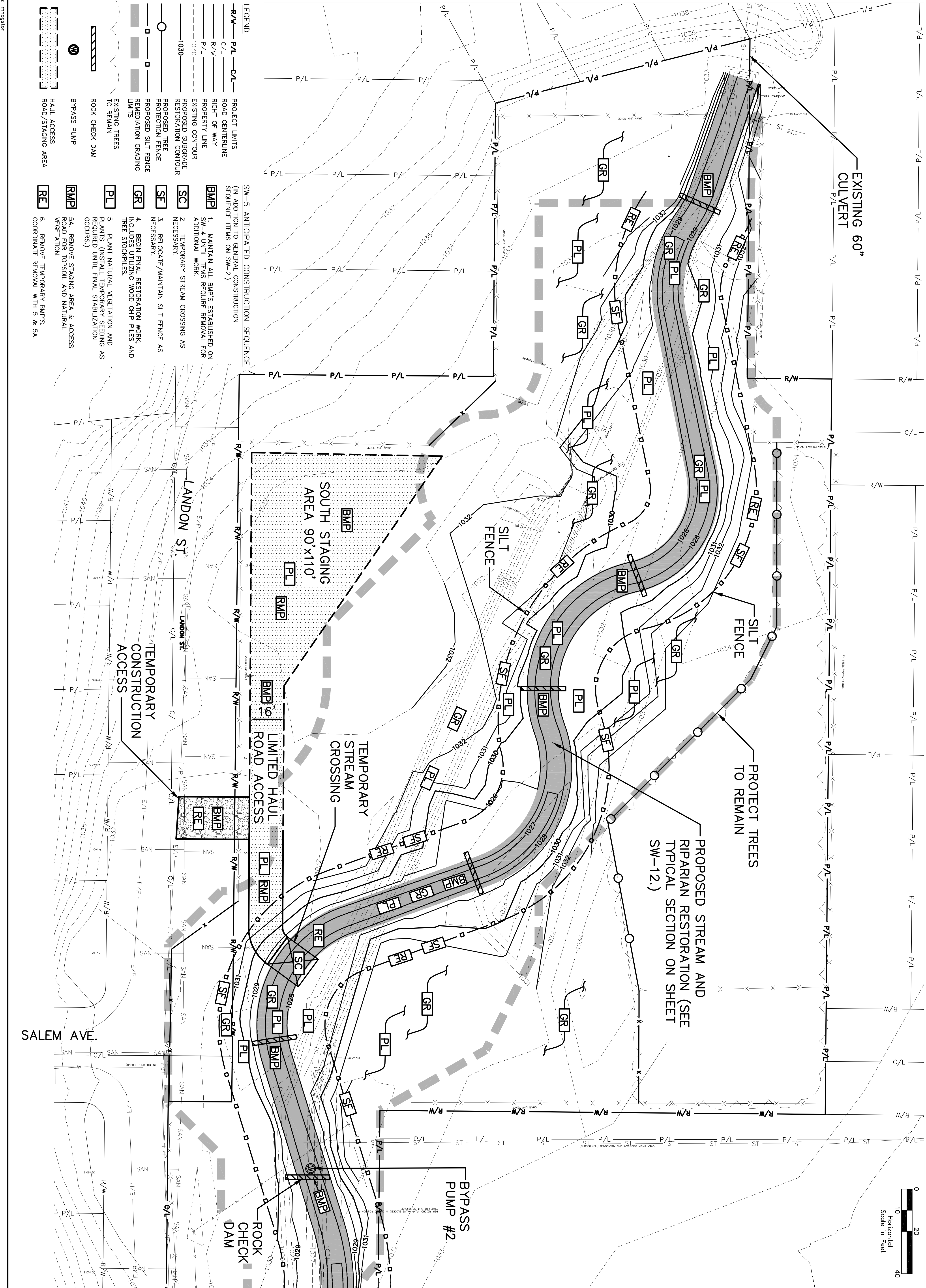

MATCHLINE SEE SHEET SW-8

DESIGNED		DATE
JR	4-16-09	
DRAWN		DATE
MLH	4-16-09	
CHECKED		DATE
MLH	4-17-09	

SW-5

2009213.00

JOB NO.	
2009213.00	

HALEY'S DITCH
REMEDIATION AND RESTORATION
GRADING & SWP3

SOUTH WORK ZONE - STAGE 3

REV.	DATE	DESCRIPTION

GLAUS PYLE SCHWABER BURKE & DEWHEN INC.

GPD ASSOCIATES

520 South Main Street, Suite 2531
Akron, Ohio 44311
330-572-2100 • Fax 330-572-2101

RiverWorks

A Partnership for Stream & Wetland Restoration

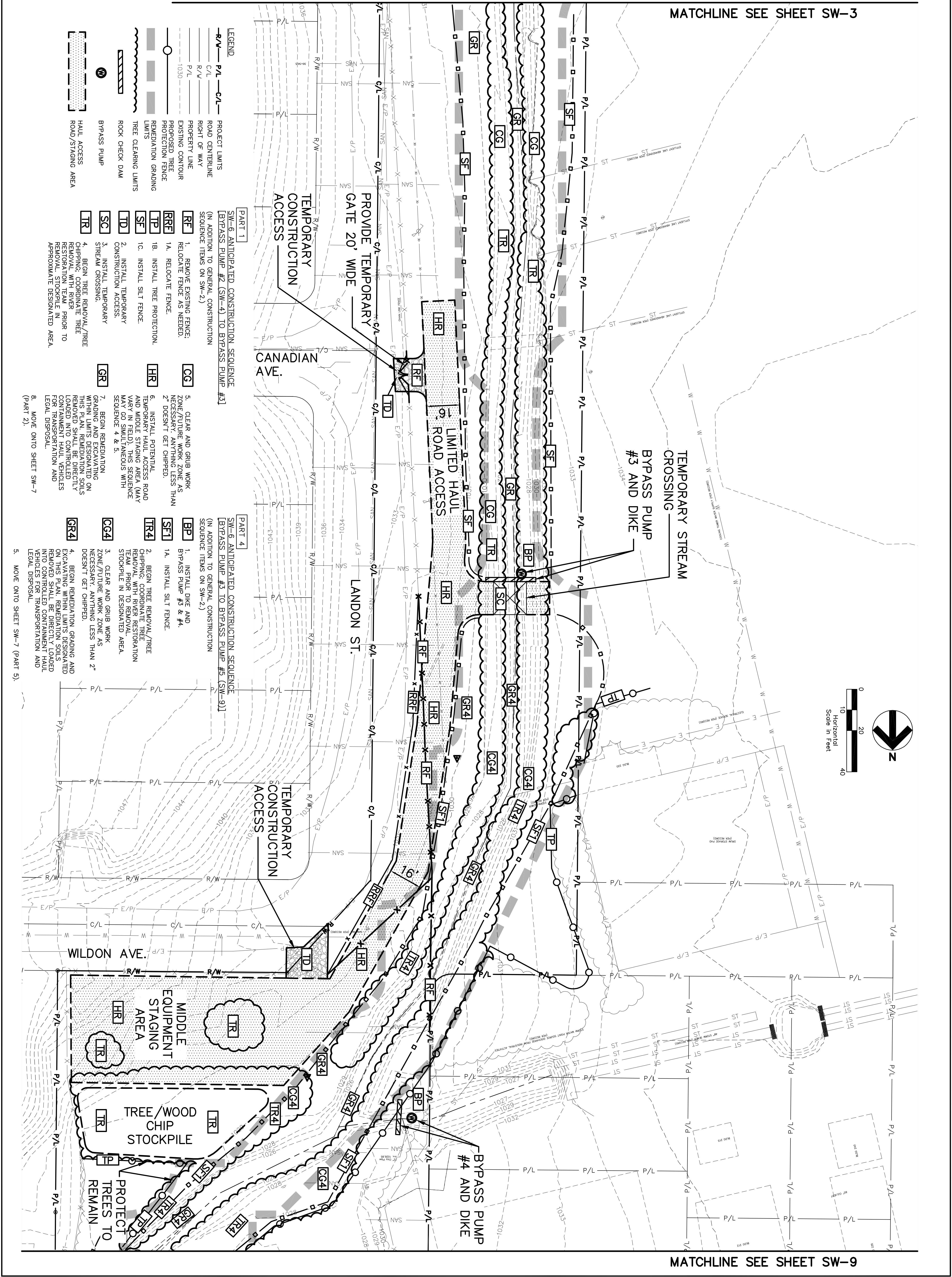

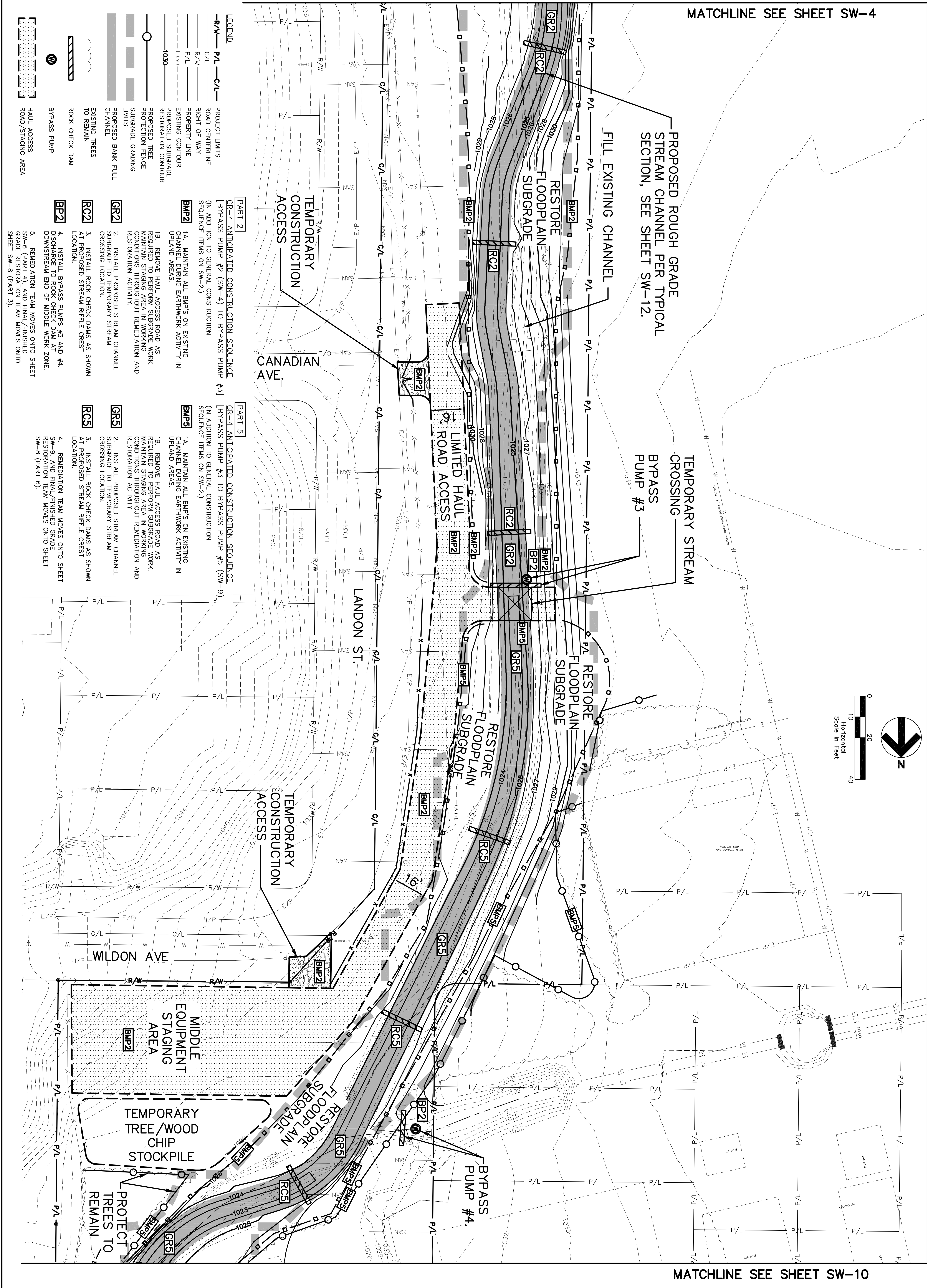

SW-7

2009213.00

DESIGNED	JR	DATE	4-16-09
DRAWN	MLH	DATE	4-16-09
CHECKED	MLH	DATE	4-17-09

HALEY'S DITCH
REMEDIATION AND RESTORATION
GRADING & SWP3

MIDDLE WORK ZONE - STAGE 2

REV.	DATE	DESCRIPTION

GLAIS PYLE SCHWEN BURKE & DEWHEN INC.

GPD ASSOCIATES

520 South Main Street, Suite 2531
Akron, Ohio 44311
330-572-2100 • Fax 330-572-2101

RiverWorks

A Partnership for Stream & Wetland Restoration



CLAUIS PYLE SCHOMER BURNS & DEHAVEN INC.

GPD 
ASSOCIATES

520 South Main Street, Suite 2531
Akron, Ohio 44311
330-572-2100, Fax 330-572-2101



HALEY'S DITCH

REMEDICATION AND RESTORATION

GRADING & SWP3

MIDDLE WORK ZONE - STAGE 3

	DATE
DESIGNED JR	4-16-09
DRAWN MLH	4-16-09
CHECKED MAL	4-17-09

JOB NO.
2009213.00

SW-8

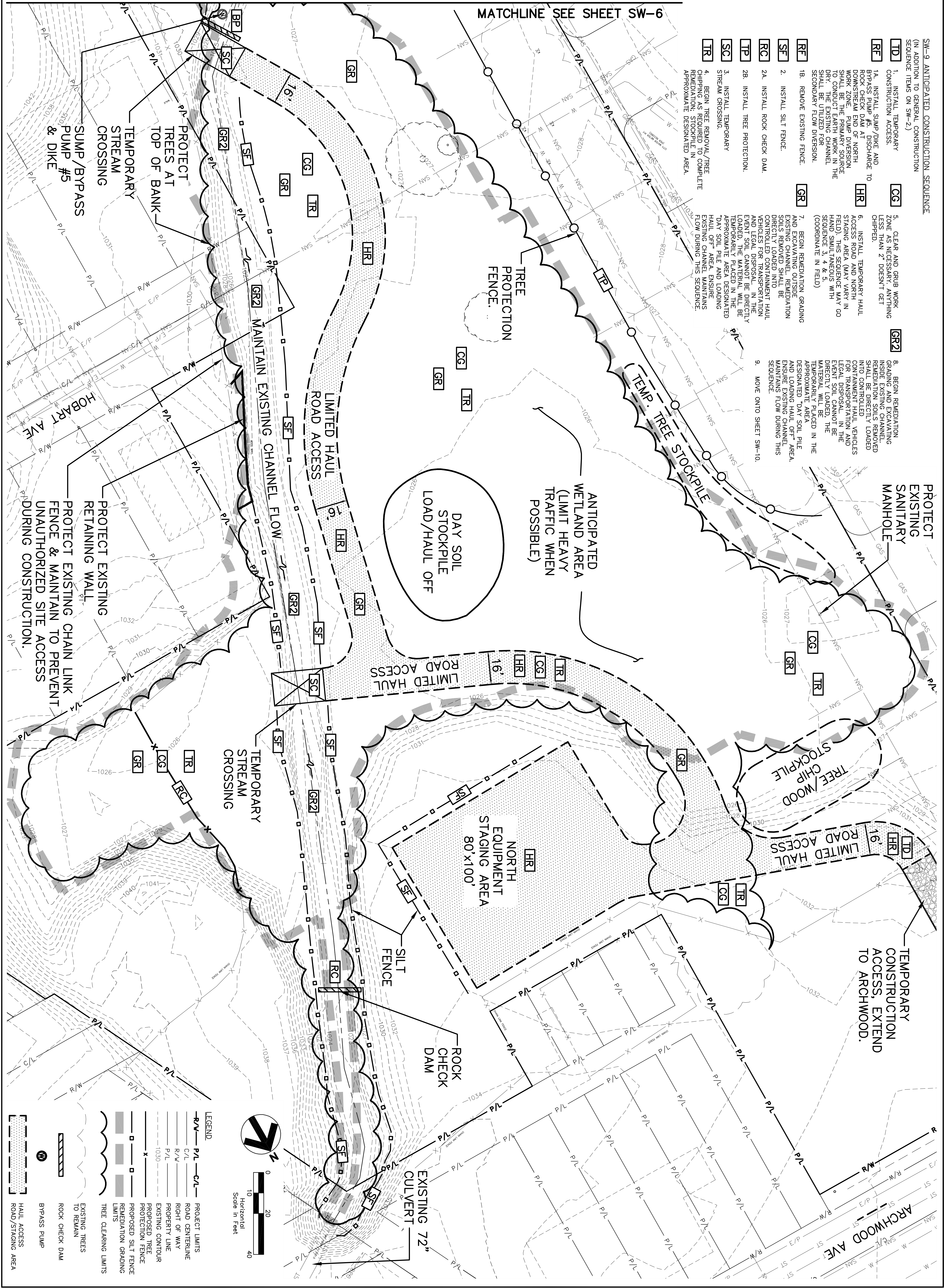

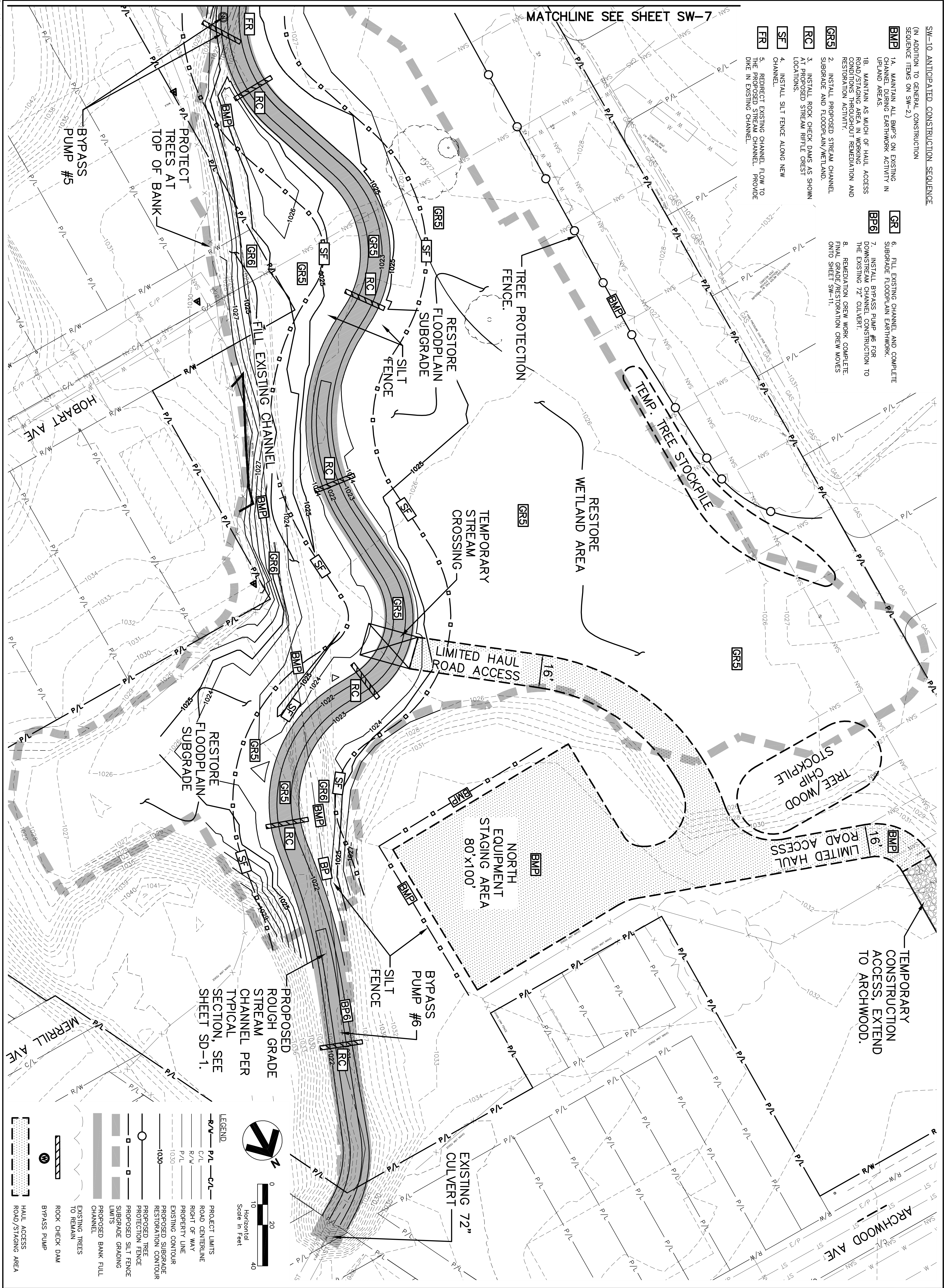

REV.	DATE	DESCRIPTION

CLAUS PYLE SCHOWER BURNS & DEHAVEN INC.

GPD 

ASSOCIATES

520 South Main Street, Suite 2531
Akron, Ohio 44311
330-572-2100, Fax 330-572-2101



RiverWorks
A Partnership for Stream & Wetland Restoration

HALEY'S DITCH

REMEDIATION AND RESTORATION

GRADING & SWP3

NORTH WORK ZONE - STAGE 2

	DATE
DESIGNED JR	4-16-09
DRAWN MLH	4-16-09
CHECKED MAL	4-17-09

JOB NO.
2009213.00

SW-10

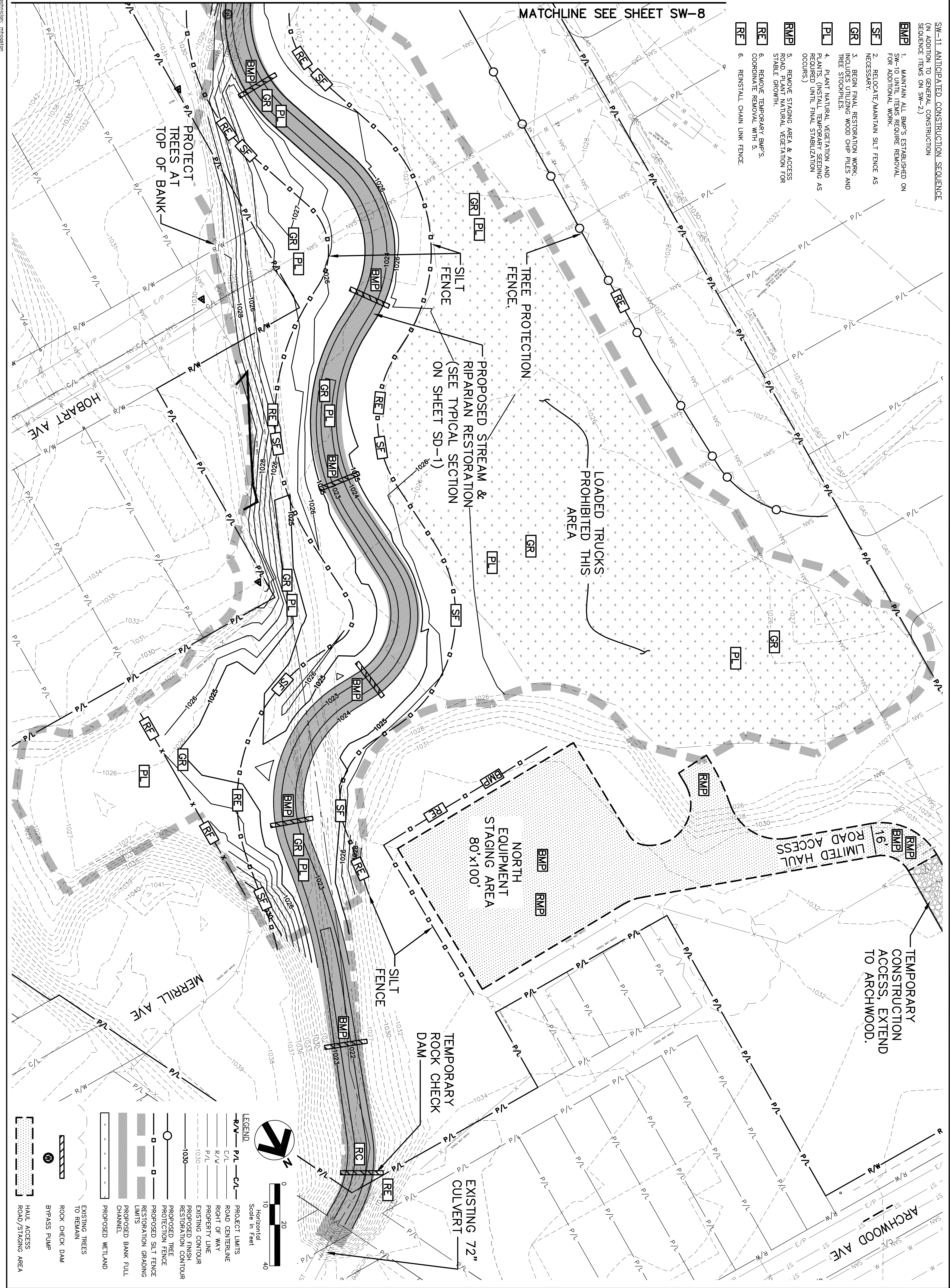

DESIGNED	JR	DATE	4-16-09
DRAWN	MLH	DATE	4-16-09
CHECKED	MLH	DATE	4-17-09

JOB NO.
2009213.00

SW-11

HALEY'S DITCH REMEDIATION AND RESTORATION GRADING & SWP3
NORTH WORK ZONE - STAGE 3

REV.	DATE	DESCRIPTION

CLAUS PYLE SCHWENBURG & OHWEN INC.

GPD ASSOCIATES

520 South Main Street, Suite 2531
Akron, Ohio 44311
330-572-2100 • Fax 330-572-2101

RiverWorks

A Partnership for Stream & Wetland Restoration

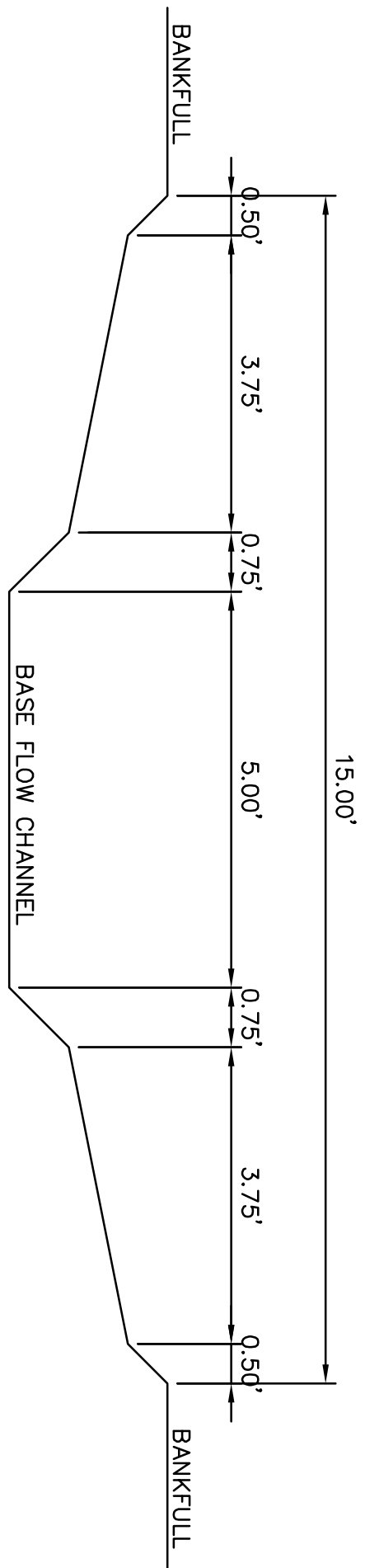

NOTE:
ROCK CHECK DAMS PLACED PER PLAN.
ROUGH GRADE BANK FULL CHANNEL TYPICAL SECTION
N.T.S.

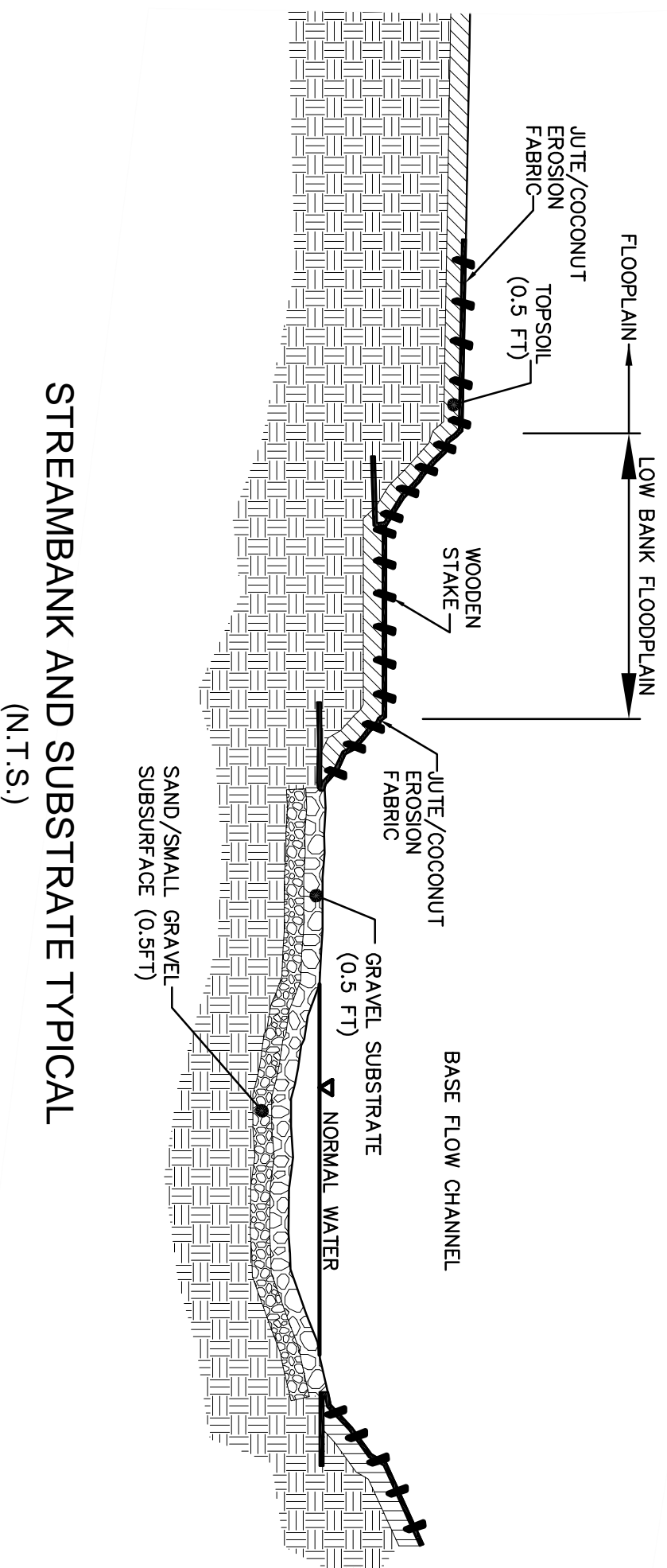
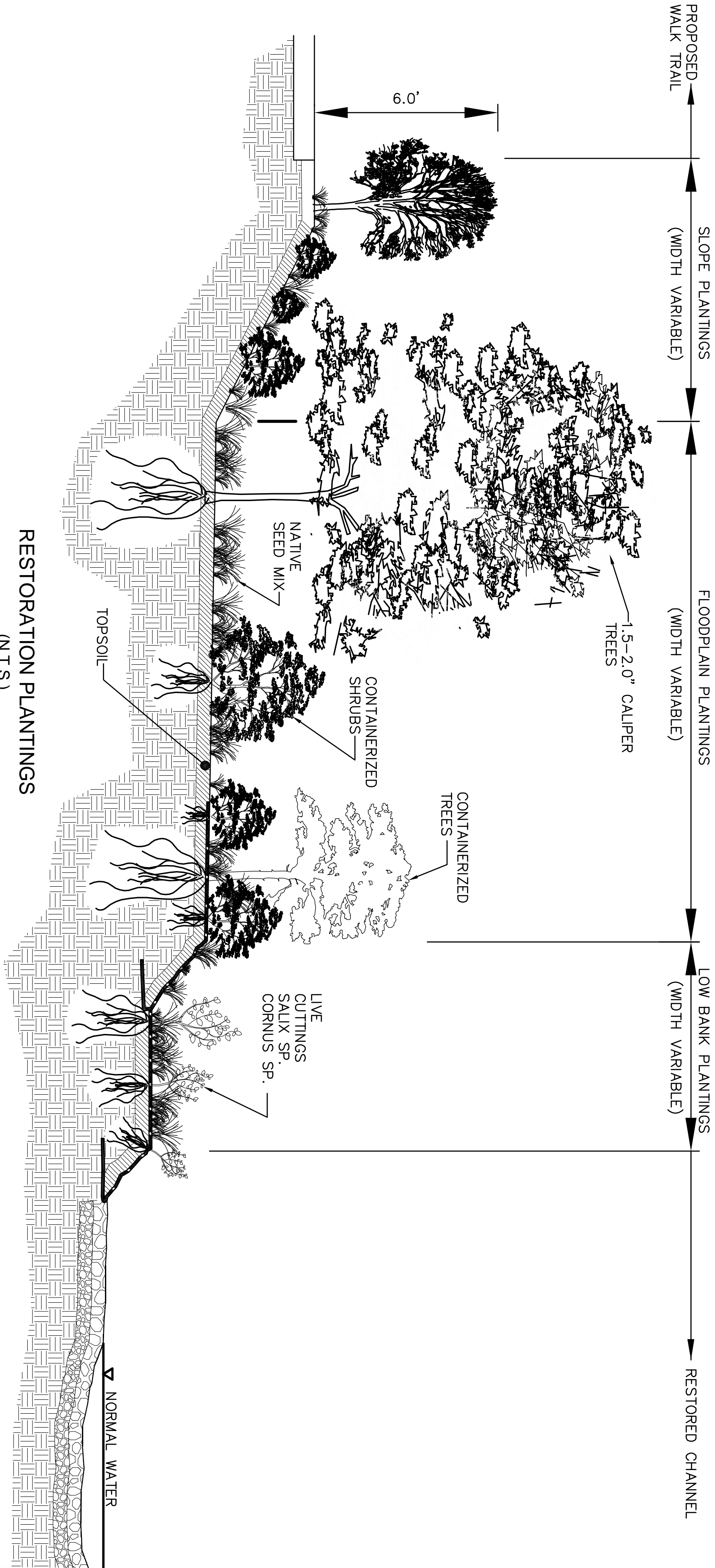

FLOODPLAIN (WIDTH VARIABLE) RIVERINE WETLAND (WIDTH VARIABLE) FLOODPLAIN (WIDTH VARIABLE) RESTORED CHANNEL

RESTORATION PLANTINGS
(N.T.S.)



STREAM & RIPARIAN RESTORATION TYPICAL SECTION
N.T.S.

REV.	DATE	DESCRIPTION

HALEY'S DITCH
REMEDIATION AND RESTORATION
GRADING & SWP3

SITE DETAILS

DESIGNED	DATE
JR	4-16-09
DRAWN	DATE
MLH	4-16-09
CHECKED	DATE
MLH	4-17-09

JOB NO.
2009213.00

SW-12

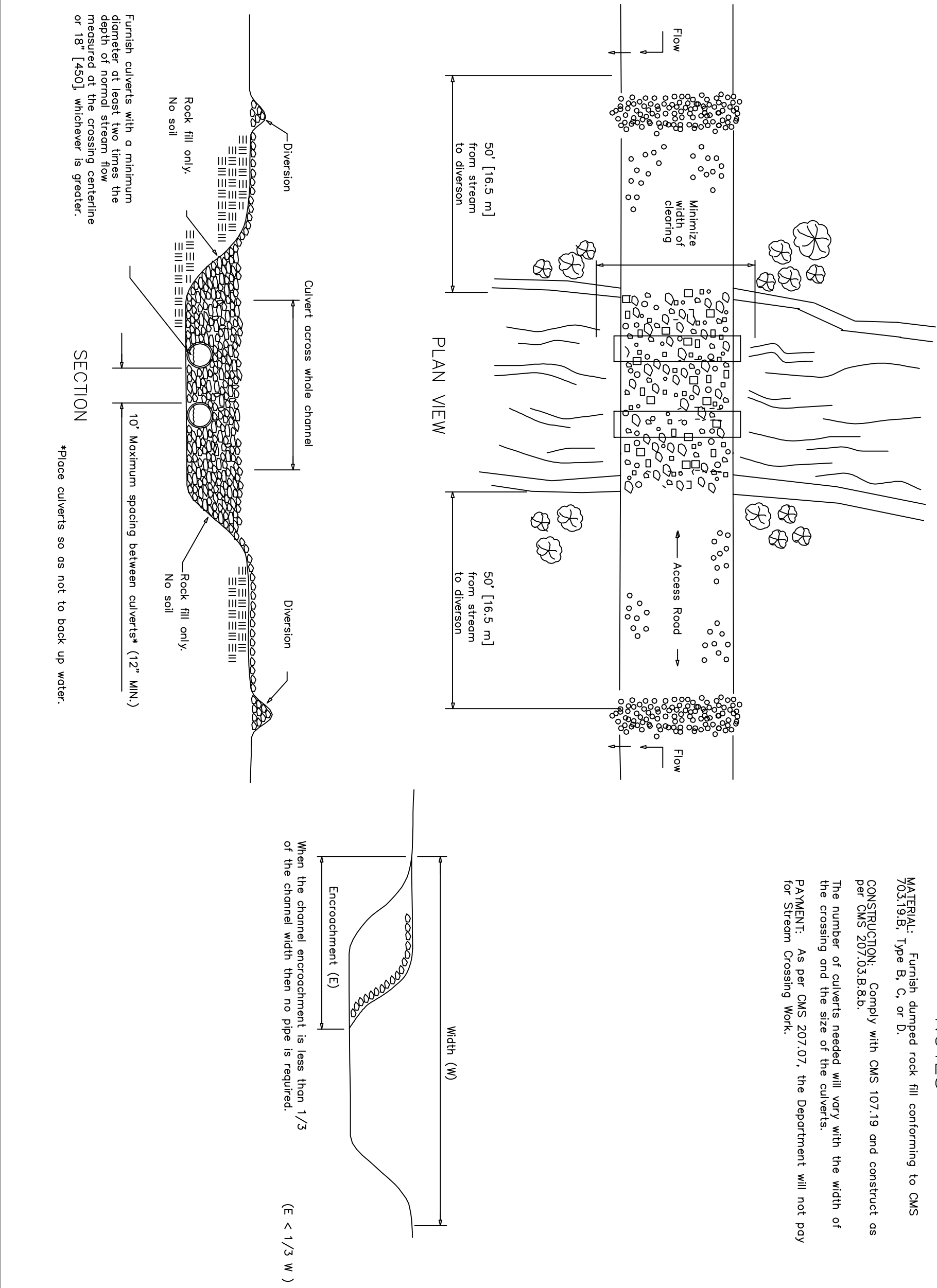

MATERIAL: Furnish designed rock fill conforming to CMS 703.19-B, Type B, C, or D.

CONSTRUCTION: Comply with CMS 107.19 and construct as per CMS 207.03-B.8.b.

The number of culverts needed will vary with the width of the crossing and the size of the culverts.

PAYMENT: As per CMS 207.07, the Department will not pay for Stream Crossing Work.

1 / 1	NUMBER DM-5.1	STANDARD HYDRAULIC CONSTRUCTION DRAWING STREAM AND RIVER CROSSINGS	OFFICE OF STRUCTURAL ENGINEERING	All metric dimensions (in brackets ()) are in millimeters unless otherwise noted.	HYDRAULIC ENGINEER D. Gruver	DATE 7-19-02	OHO DEPARTMENT OF TRANSPORTATION <i>Tim Kelle</i> ENGINEER OF BRIDGES
-------	------------------	---	--	---	------------------------------------	-----------------	---

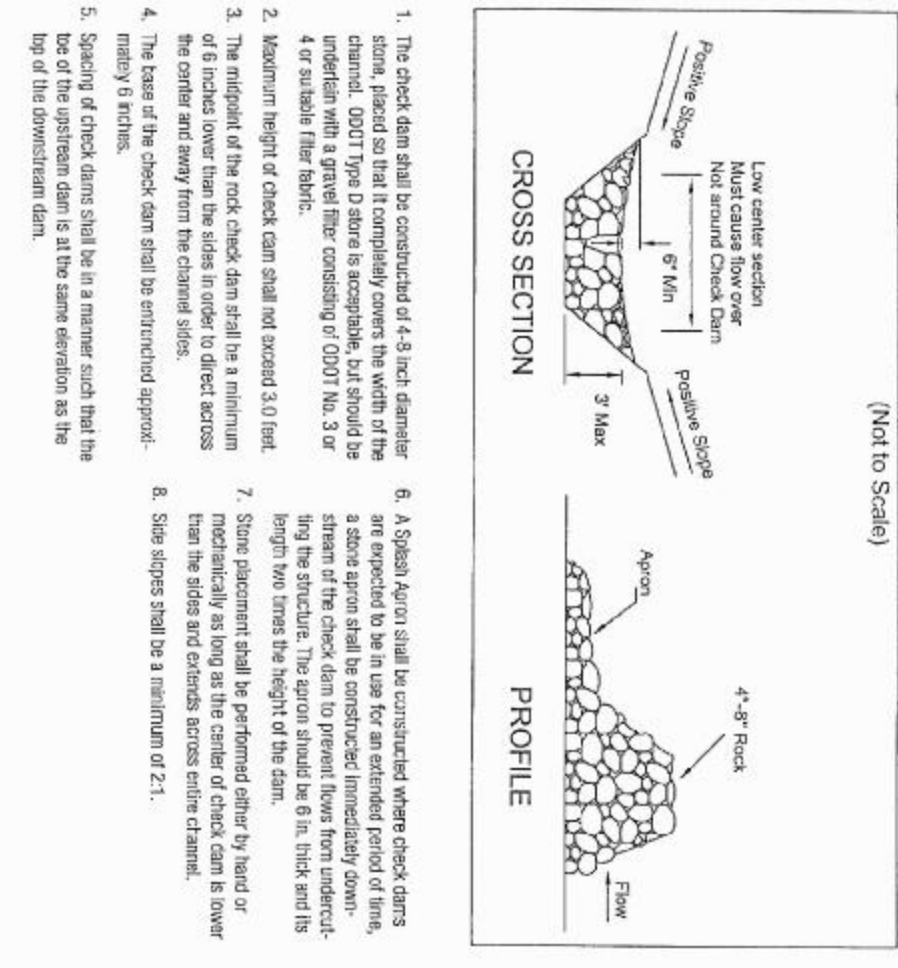
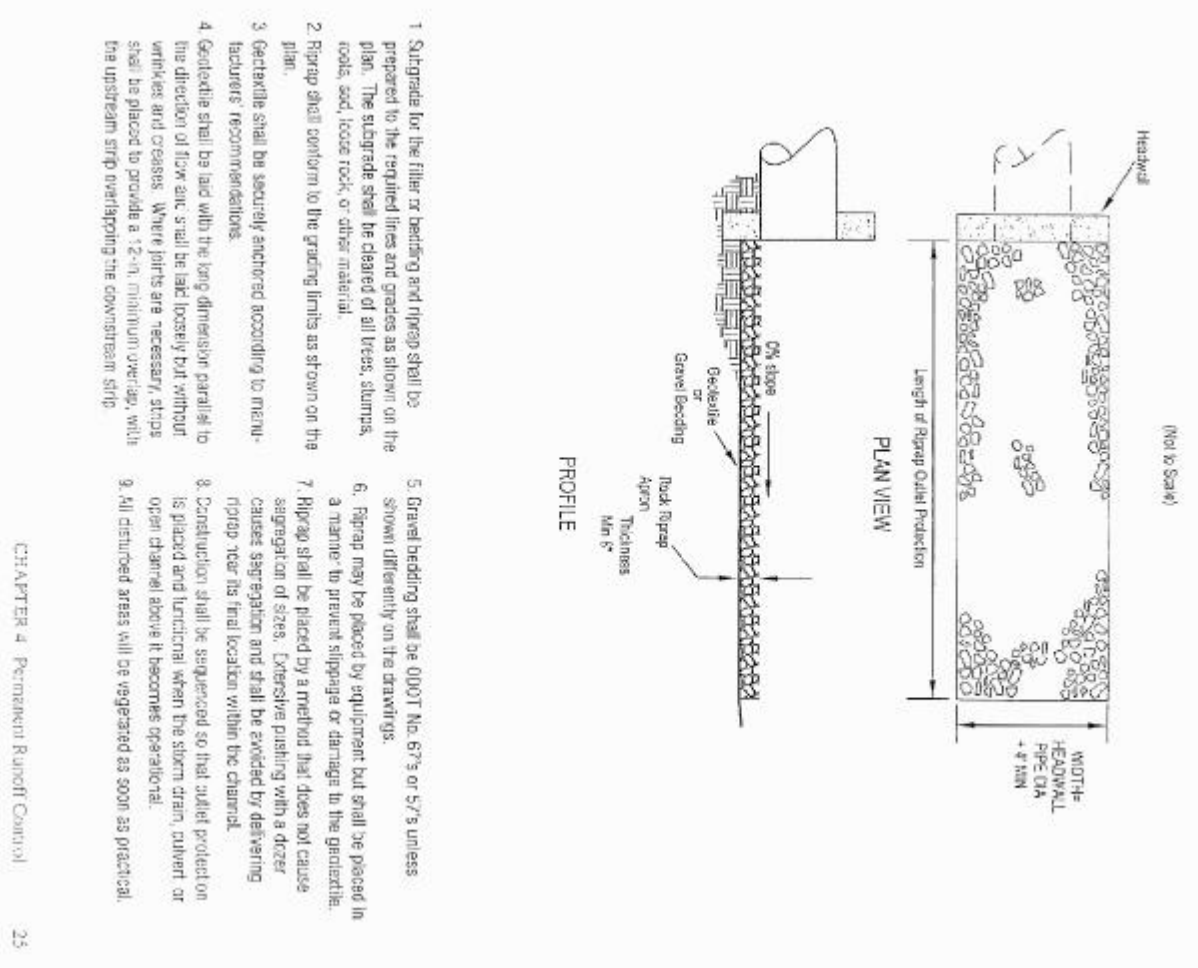

1. STONE SIZE - NO. 2 STONE SHALL BE USED, OR RECYCLED CONCRETE EQUIVALENT.
2. THE CONSTRUCTION ENTRANCE SHALL COINCIDE WITH THE PROPOSED DRIVE AS SHOWN ON THE PLAN.
3. THICKNESS - STONE LAYER SHALL BE 6" THICK FOR STANDARD DUTY ACTIVITY AND 10" THICK FOR HEAVY DUTY ACTIVITY.
4. DRAINAGE AND SLOPE - THE ENTRANCE SHALL BE AT LEAST 16" WIDE, DRAINAGE SHALL BE TO THE SIDE OF THE DRIVE AND SHALL UTILIZE THE CONSTRUCTION ENTRANCE UNTIL PAVEMENT IS IN PLACE.
5. BEDDING - A GEOTECHNICAL SHALL BE PLACED OVER THE ENTIRE AREA PRIOR TO PLACING STONE. IT SHALL HAVE A GRAB TENSILE STRENGTH OF AT LEAST 200 LBS. AND A WULLEN BURST STRENGTH OF AT LEAST 190 LBS.
6. CULVERT - A PIPE OR CULVERT SHALL BE CONSTRUCTED UNDER THE ENTRANCE IF NEEDED TO PREVENT SURFACE WATER FLOWING ACROSS THE ENTRANCE. THE CULVERT SHALL BE CONSTRUCTED AS PART OF THE WATER BAR - A WATER BAR SHALL BE CONSTRUCTED AS PART OF THE CONSTRUCTION ENTRANCE IF NEEDED TO PREVENT SURFACE RUNOFF FROM FLOWING THE LENGTH OF THE CONSTRUCTION ENTRANCE AND OUT ONTO PAVED SURFACES.
7. MAINTENANCE - TOP DRESSING OF ADDITIONAL STONE SHALL BE APPLIED UNDER CONDITIONS DEMAND, AND SPILLED, DROPPED, WASHED OR TRACKED INTO THE DRIVEWAY AND DRIVEWAY SURFACES SHALL BE IMMEDIATELY REMOVED BY SEEDMENT CONTROLS. SHALL BE REMOVED IMMEDIATELY. REMOVAL SHALL BE ACCOMPLISHED BY SCRAPING OR SWEEPING.
8. CONSTRUCTION ENTRANCES SHALL NOT BE RELIED UPON TO REMOVE MUD FROM VEHICLES AND PREVENT OFF SITE TRACKING. VEHICLES THAT ENTER AND LEAVE THE CONSTRUCTION SHALL BE RESTRICTED FROM MUDDY AREAS.

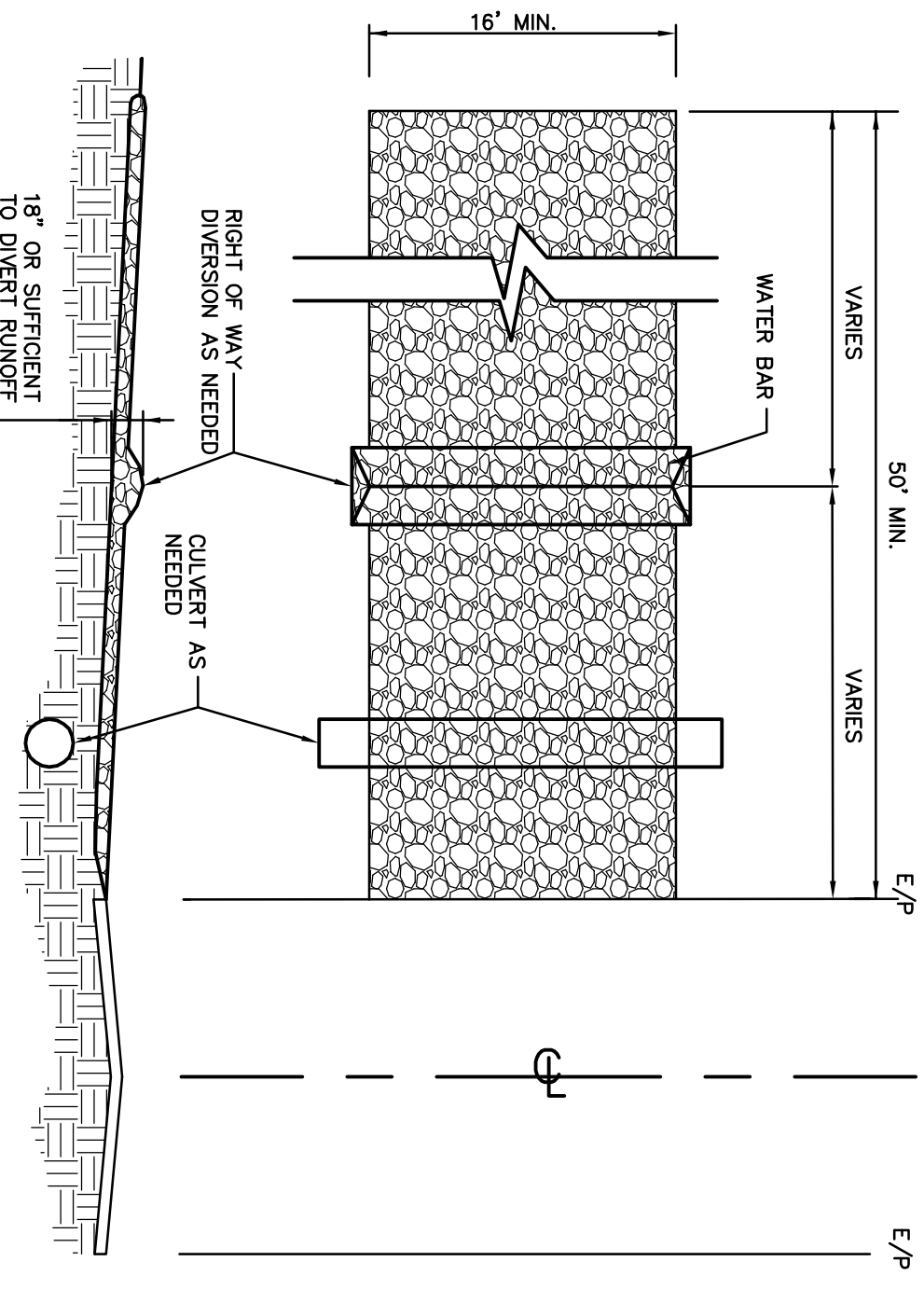

REV.	DATE	DESCRIPTION

HALEY'S DITCH

REMEDIATION AND RESTORATION

GRADING & SWP3

SITE DETAILS

	DATE
DESIGNED	
JR	4-16-09
DRAWN	
MLH	4-16-09
CHECKED	
MAL	4-17-09

JOB NO.
2009213.00

SV-13